

	Existing No Waiting at Any Time (Double Yellow Lines) restrictions
	Proposed No Waiting at Any Time (Double Yellow Lines) restrictions
	Proposed No Waiting Monday-Sunday 8am-6pm (Single Yellow Line) restrictions

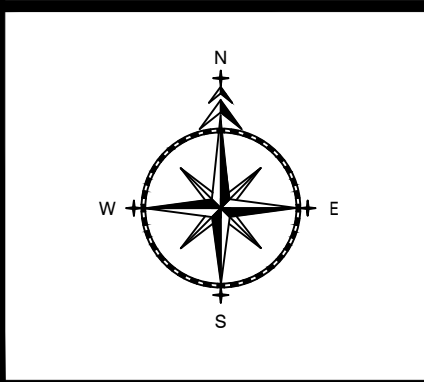
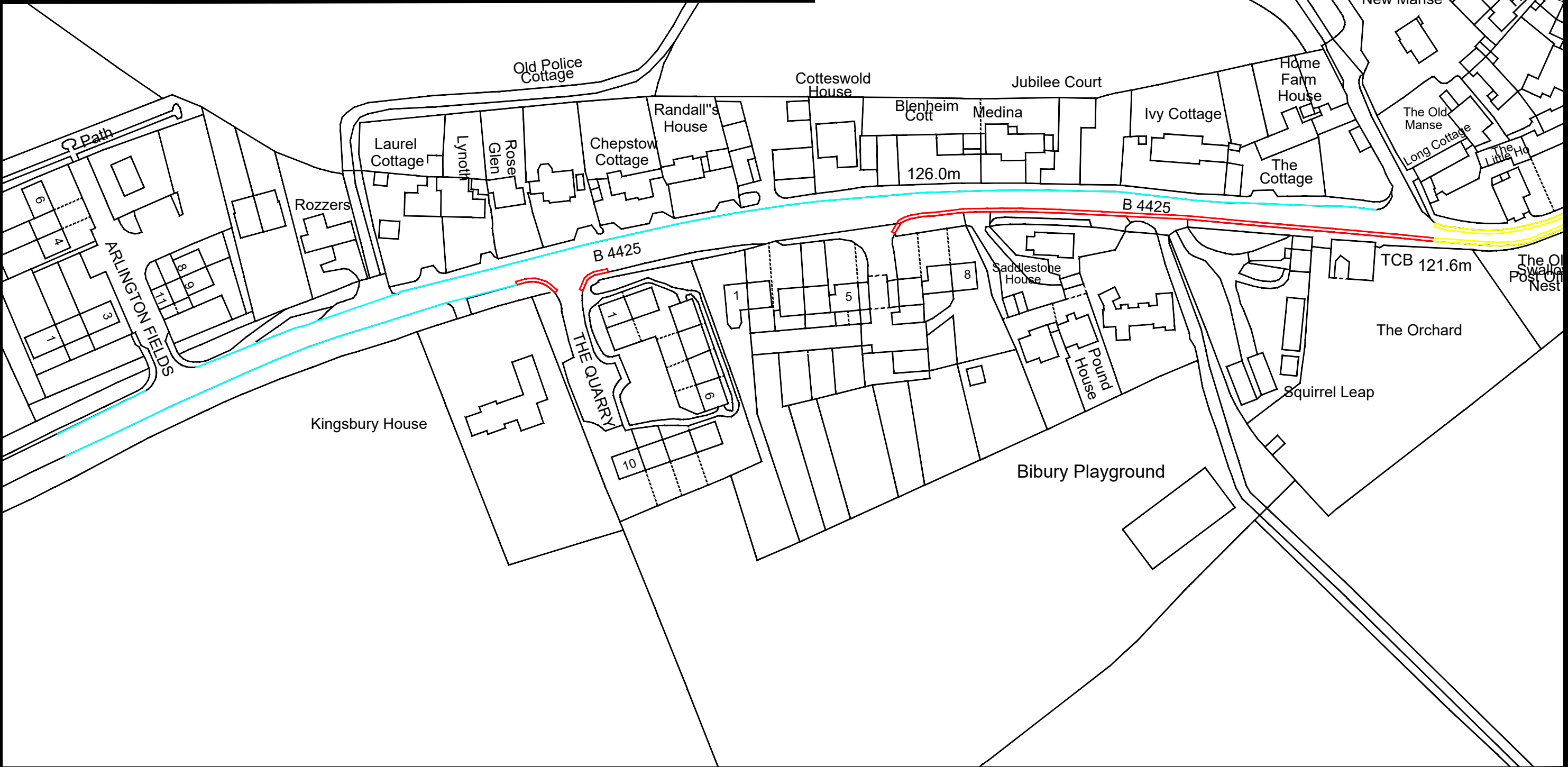

TRO TRAFFIC REGULATION ORDERS LTD

ADL House
The Oaklands Business Park
Yate, Bristol
BS37 5NA
Tel : 01454 332100
Fax : 01454 327983
E-Mail : Will@TROldt.CO.UK

NOTES



1. PRELIMINARY DESIGN PROVIDED FOR ILLUSTRATIVE PURPOSES ONLY. ALL DETAILS ARE SUBJECT TO INCLUDING CHECKING STATUTORY SERVICE APPARATUS.
2. DO NOT SCALE FROM THIS DRAWING.
3. BACKGROUND PLAN IS BASED UPON A DIGITAL OSBASE.
4. ALL DETAILS TO BE CONFIRMED ON SITE AND ON A TOPOGRAPHICAL SURVEY.
5. ALL TRACKS ASSUME GRADIENTS AND CAMBERS DO NOT EXCEED 1:60 AND 1:40 RESPECTIVELY OTHERWISE VEHICLE MANOEUVRABILITY MAY BE AFFECTED.
6. ALL LAND OWNERSHIP DETAILS, EXTENT OF ADOPTED HIGHWAY AND RIGHTS OF WAY TO BE CONFIRMED.
7. ASSUMES ALL LANDSCAPING CAN BE ALTERED AND NO TREES ARE SUBJECT TO TPO.

© Copyright Traffic Regulation Orders Ltd

AMENDMENTS		
REF.	DATE	DESCRIPTION

ADL Job No. 5227-17

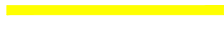
Project B4425 (Western Extent) Bibury			
Title Proposed Waiting Restrictions			
Date Nov 2022	Drawn WC		
Checked TH	Date 20.12.22	Approved TH	Date 20.12.22
Scale NTS@A3	Drg No. 5227-17-001	Rev.	

 Existing No Waiting at Any Time (Double Yellow Lines) restrictions
 Proposed No Waiting at Any Time (Double Yellow Lines) restrictions to be removed
 Proposed Limited Waiting 8am-6pm, 3 hours, no return within 4 hours

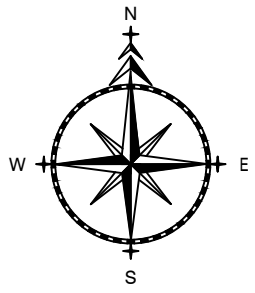
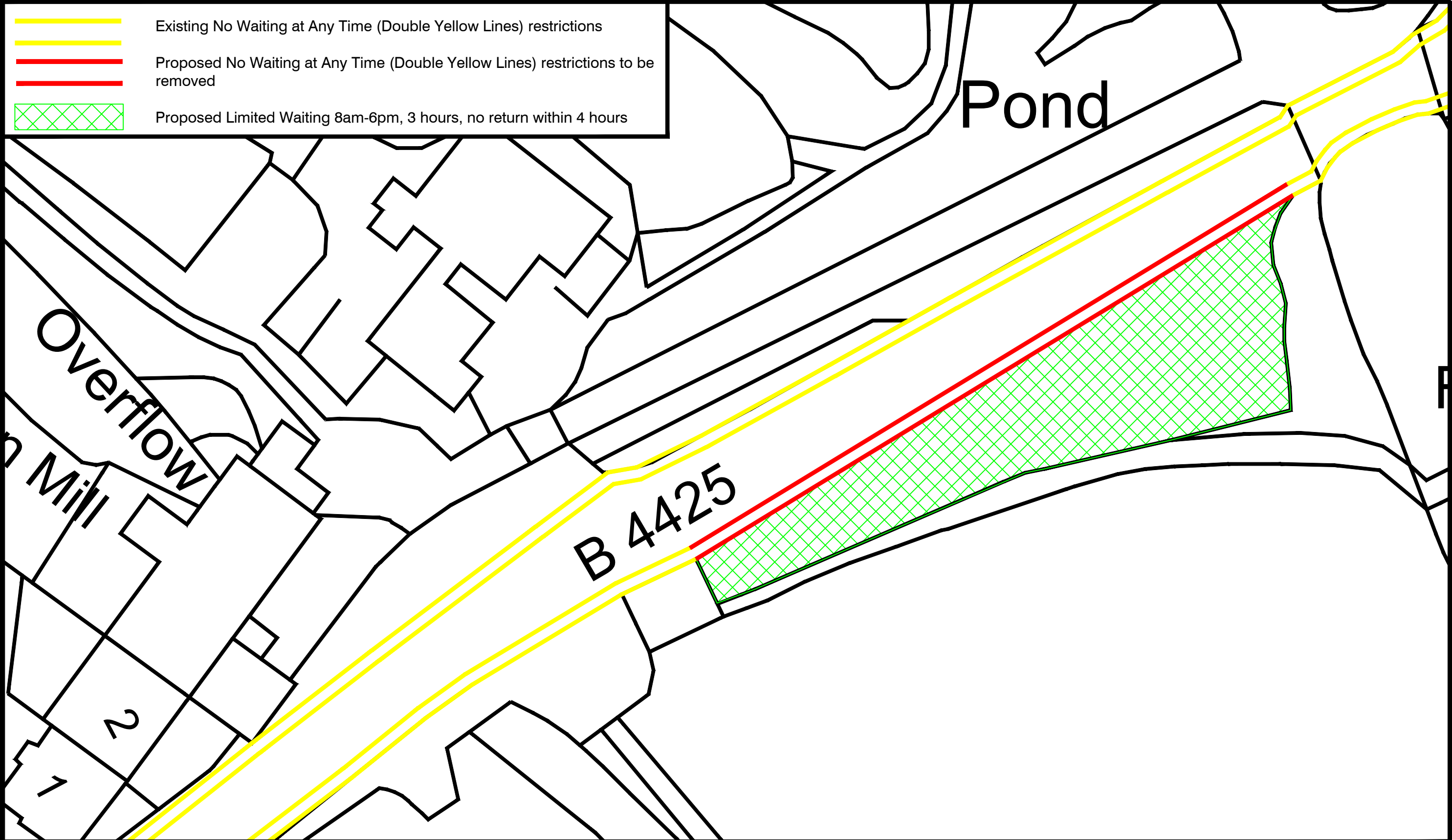

TRO TRAFFIC REGULATION ORDERS LTD

ADL House
 The Oaklands Business Park
 Yate, Bristol
 BS37 5NA
 Tel : 01454 332100
 Fax : 01454 327983
 E-Mail : Will@TROldt.CO.UK

NOTES
 1. PRELIMINARY DESIGN PROVIDED FOR ILLUSTRATIVE PURPOSES ONLY. ALL DETAILS ARE SUBJECT TO INCLUDING CHECKING STATUTORY SERVICE APPARATUS.
 2. DO NOT SCALE FROM THIS DRAWING.
 3. BACKGROUND PLAN IS BASED UPON A DIGITAL OSBASE.
 4. ALL DETAILS TO BE CONFIRMED ON SITE AND ON A TOPOGRAPHICAL SURVEY.
 5. ALL TRACKS ASSUME GRADIENTS AND CAMBERS DO NOT EXCEED 1:60 AND 1:40 RESPECTIVELY OTHERWISE VEHICLE MANOEUVRABILITY MAY BE AFFECTED.
 6. ALL LAND OWNERSHIP DETAILS, EXTENT OF ADOPTED HIGHWAY AND RIGHTS OF WAY TO BE CONFIRMED.
 7. ASSUMES ALL LANDSCAPING CAN BE ALTERED AND NO TREES ARE SUBJECT TO TPO.
 © Copyright Traffic Regulation Orders Ltd

AMENDMENTS		
REF.	DATE	DESCRIPTION

ADL Job No. 5227-17

Project Car Park & Bridge Bibury			
Title Proposed Restrictions			
Date Nov 2022	Drawn LO		
Checked WC	Date 04.11.22	Approved TH	Date 04.11.22
Scale NTS@A3	Drg No. 5227-17-002		Rev.

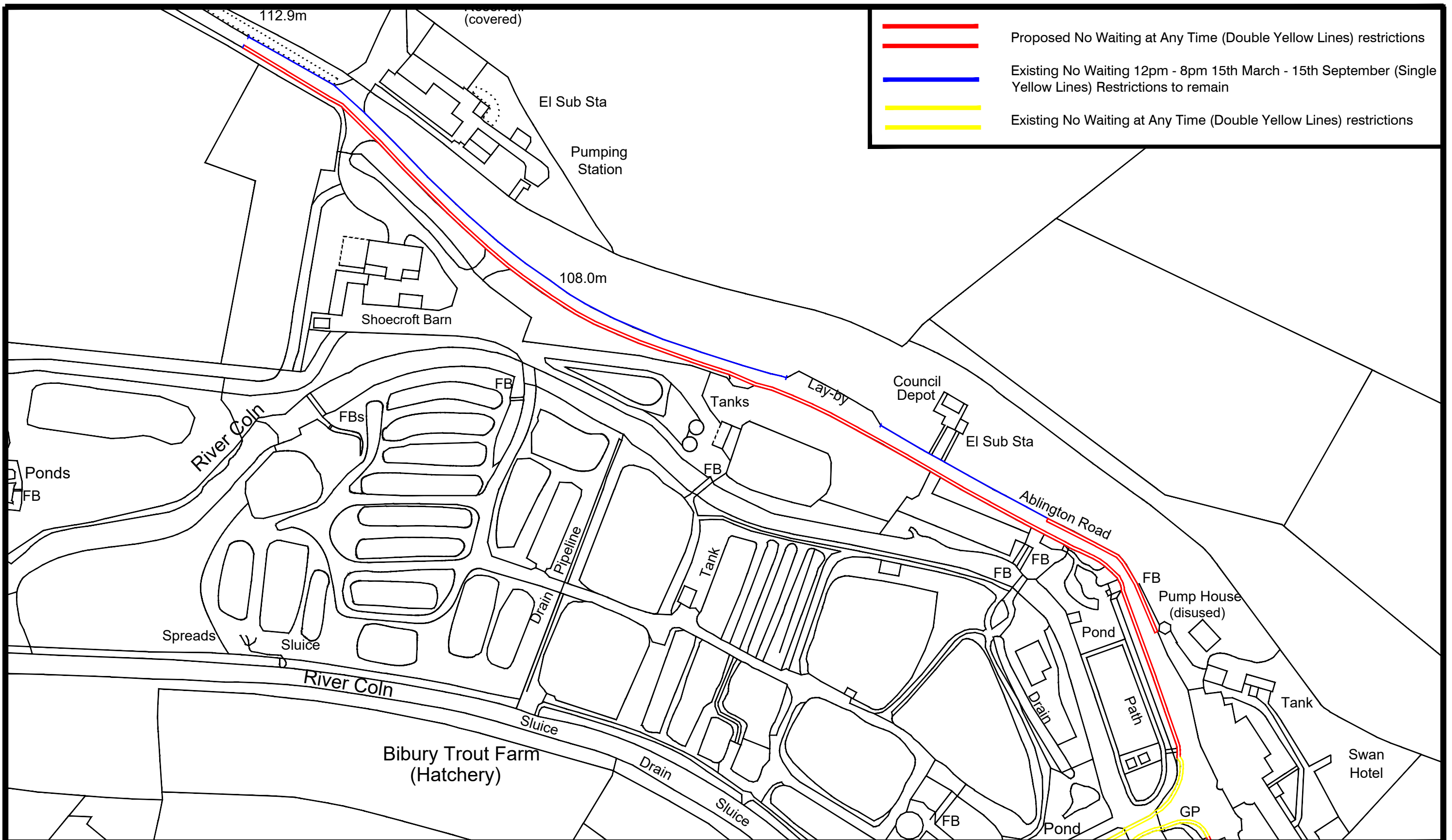

	Proposed No Waiting at Any Time (Double Yellow Lines) restrictions
	Existing No Waiting 12pm - 8pm 15th March - 15th September (Single Yellow Lines) Restrictions to remain
	Existing No Waiting at Any Time (Double Yellow Lines) restrictions

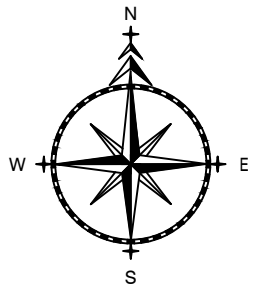

TRO TRAFFIC REGULATION ORDERS LTD

ADL House
The Oaklands Business Park
Yate, Bristol
BS37 5NA
Tel : 01454 332100
Fax : 01454 327983
E-Mail : Will@TROldt.CO.UK

- NOTES**
- PRELIMINARY DESIGN PROVIDED FOR ILLUSTRATIVE PURPOSES ONLY. ALL DETAILS ARE SUBJECT TO INCLUDING CHECKING STATUTORY SERVICE APPARATUS.
 - DO NOT SCALE FROM THIS DRAWING.
 - BACKGROUND PLAN IS BASED UPON A DIGITAL OSBASE.
 - ALL DETAILS TO BE CONFIRMED ON SITE AND ON A TOPOGRAPHICAL SURVEY.
 - ALL TRACKS ASSUME GRADIENTS AND CAMBERS DO NOT EXCEED 1:60 AND 1:40 RESPECTIVELY OTHERWISE VEHICLE MANOEUVRABILITY MAY BE AFFECTED.
 - ALL LAND OWNERSHIP DETAILS, EXTENT OF ADOPTED HIGHWAY AND RIGHTS OF WAY TO BE CONFIRMED.
 - ASSUMES ALL LANDSCAPING CAN BE ALTERED AND NO TREES ARE SUBJECT TO TPO.
- © Copyright Traffic Regulation Orders Ltd





AMENDMENTS

REF.	DATE	DESCRIPTION

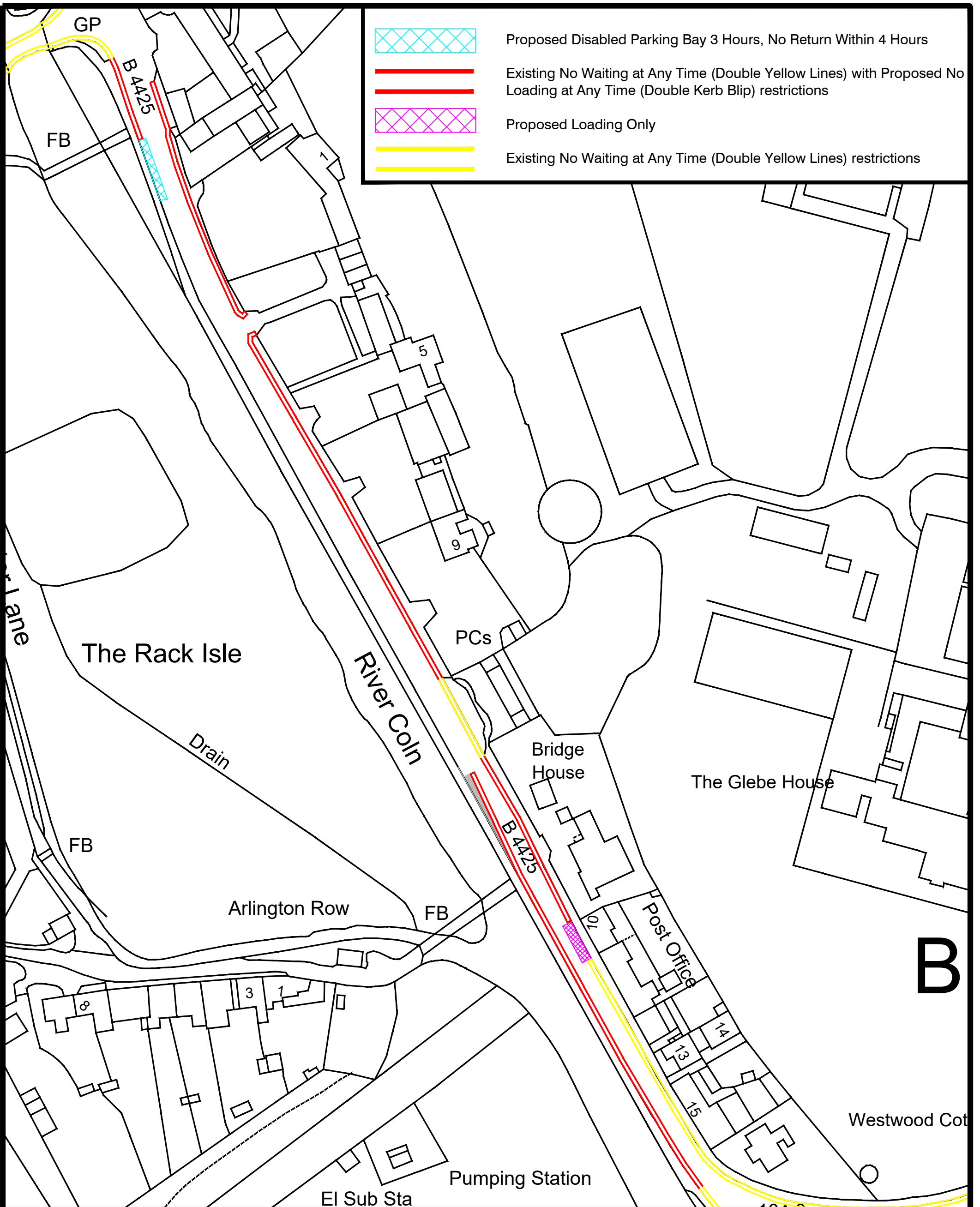
ADL Job No. 5227-17

Project Ablington Road Bibury			
Title Proposed No Waiting at Any Time Restrictions			
Date Feb 2022	Drawn WC		
Checked WW	Date 21.02.22	Approved TH	Date 21.02.22
Scale NTS@A3	Drg No. 5227-17-003		Rev.

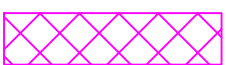

	Proposed Disabled Parking Bay 3 Hours, No Return Within 4 Hours
	Existing No Waiting at Any Time (Double Yellow Lines) with Proposed No Loading at Any Time (Double Kerb Blip) restrictions
	Proposed Loading Only
	Existing No Waiting at Any Time (Double Yellow Lines) restrictions

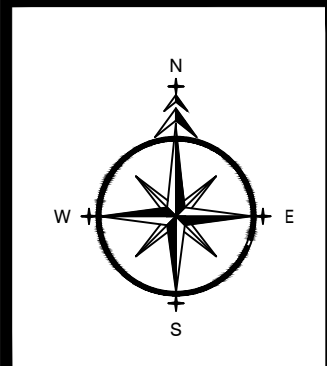

TRO TRAFFIC REGULATION ORDERS LTD

ADL House
The Oaklands Business Park
Yate, Bristol
BS37 5NA
Tel : 01454 332100
E-Mail : CAD@TROLTD.CO.UK

NOTES

1. PRELIMINARY DESIGN PROVIDED FOR ILLUSTRATIVE PURPOSES ONLY. ALL DETAILS ARE SUBJECT TO INCLUDING CHECKING STATUTORY SERVICE APPARATUS.
2. DO NOT SCALE FROM THIS DRAWING.
3. BACKGROUND PLAN IS BASED UPON A DIGITAL OSBASE.
4. ALL DETAILS TO BE CONFIRMED ON SITE AND ON A TOPOGRAPHICAL SURVEY.
5. ALL TRACKS ASSUME GRADIENTS AND CAMBERS DO NOT EXCEED 1:80 AND 1:40 RESPECTIVELY OTHERWISE VEHICLE MANOEUVRABILITY MAY BE AFFECTED.
6. ALL LAND OWNERSHIP DETAILS, EXTENT OF ADOPTED HIGHWAY AND RIGHTS OF WAY TO BE CONFIRMED.
7. ASSUMES ALL LANDSCAPING CAN BE ALTERED AND NO TREES ARE SUBJECT TO TPO.



© Copyright Traffic Regulation Orders Ltd

AMENDMENTS		
REF.	DATE	DESCRIPTION

ADL Job No. 5227-17

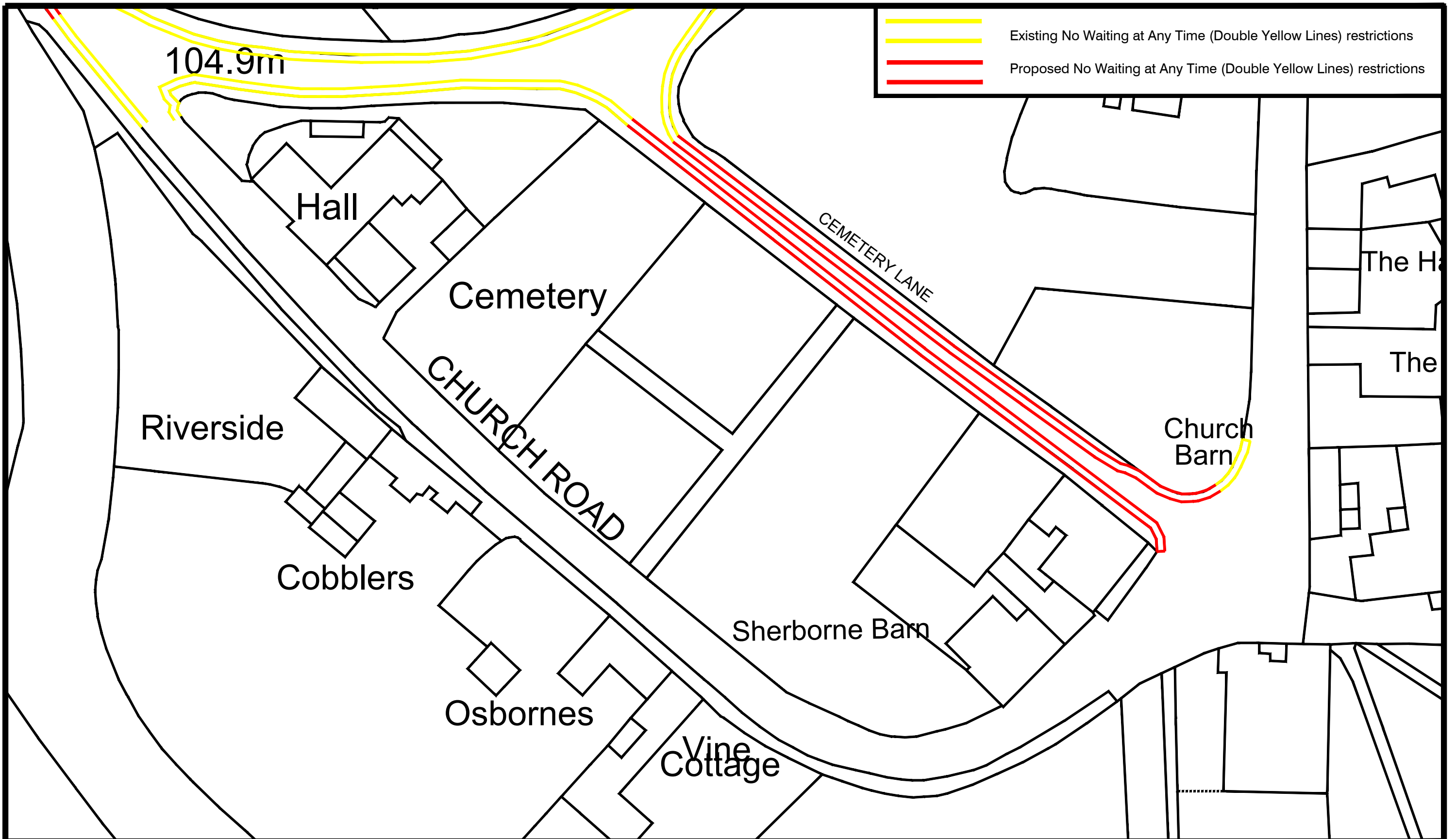
Project The Street (B4425) Bibury			
Title Proposed Restrictions			
Date Nov 2022	Drawn LO		
Checked WC	Date 04.11.22	Approved TH	Date 04.11.22
Scale NTS @ A3	Drg No. 5227-17-004		Rev.



 Existing No Waiting at Any Time (Double Yellow Lines) restrictions
 Proposed No Waiting at Any Time (Double Yellow Lines) restrictions

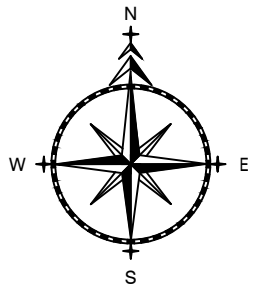

TRO TRAFFIC REGULATION ORDERS LTD

ADL House
 The Oaklands Business Park
 Yate, Bristol
 BS37 5NA
 Tel : 01454 332100
 Fax : 01454 327983
 E-Mail : Will@TROldt.CO.UK

- NOTES**
1. PRELIMINARY DESIGN PROVIDED FOR ILLUSTRATIVE PURPOSES ONLY. ALL DETAILS ARE SUBJECT TO INCLUDING CHECKING STATUTORY SERVICE APPARATUS.
 2. DO NOT SCALE FROM THIS DRAWING.
 3. BACKGROUND PLAN IS BASED UPON A DIGITAL OSBASE.
 4. ALL DETAILS TO BE CONFIRMED ON SITE AND ON A TOPOGRAPHICAL SURVEY.
 5. ALL TRACKS ASSUME GRADIENTS AND CAMBERS DO NOT EXCEED 1:60 AND 1:40 RESPECTIVELY OTHERWISE VEHICLE MANOEUVRABILITY MAY BE AFFECTED.
 6. ALL LAND OWNERSHIP DETAILS, EXTENT OF ADOPTED HIGHWAY AND RIGHTS OF WAY TO BE CONFIRMED.
 7. ASSUMES ALL LANDSCAPING CAN BE ALTERED AND NO TREES ARE SUBJECT TO TPO.
- © Copyright Traffic Regulation Orders Ltd

AMENDMENTS		
REF.	DATE	DESCRIPTION

ADL Job No. 5227-17

Project Cemetery Lane & Church Road Bibury			
Title Proposed Restrictions			
Date Nov 2022	Drawn LO		
Checked WC	Date 04.11.22	Approved TH	Date 04.11.22
Scale NTS@A3	Drg No. 5227-17-005		Rev.

Proposed No Waiting at Any Time (Double Yellow Lines) restrictions

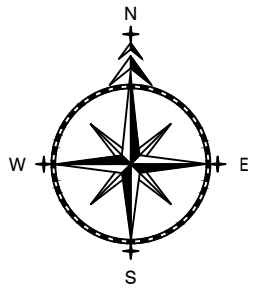
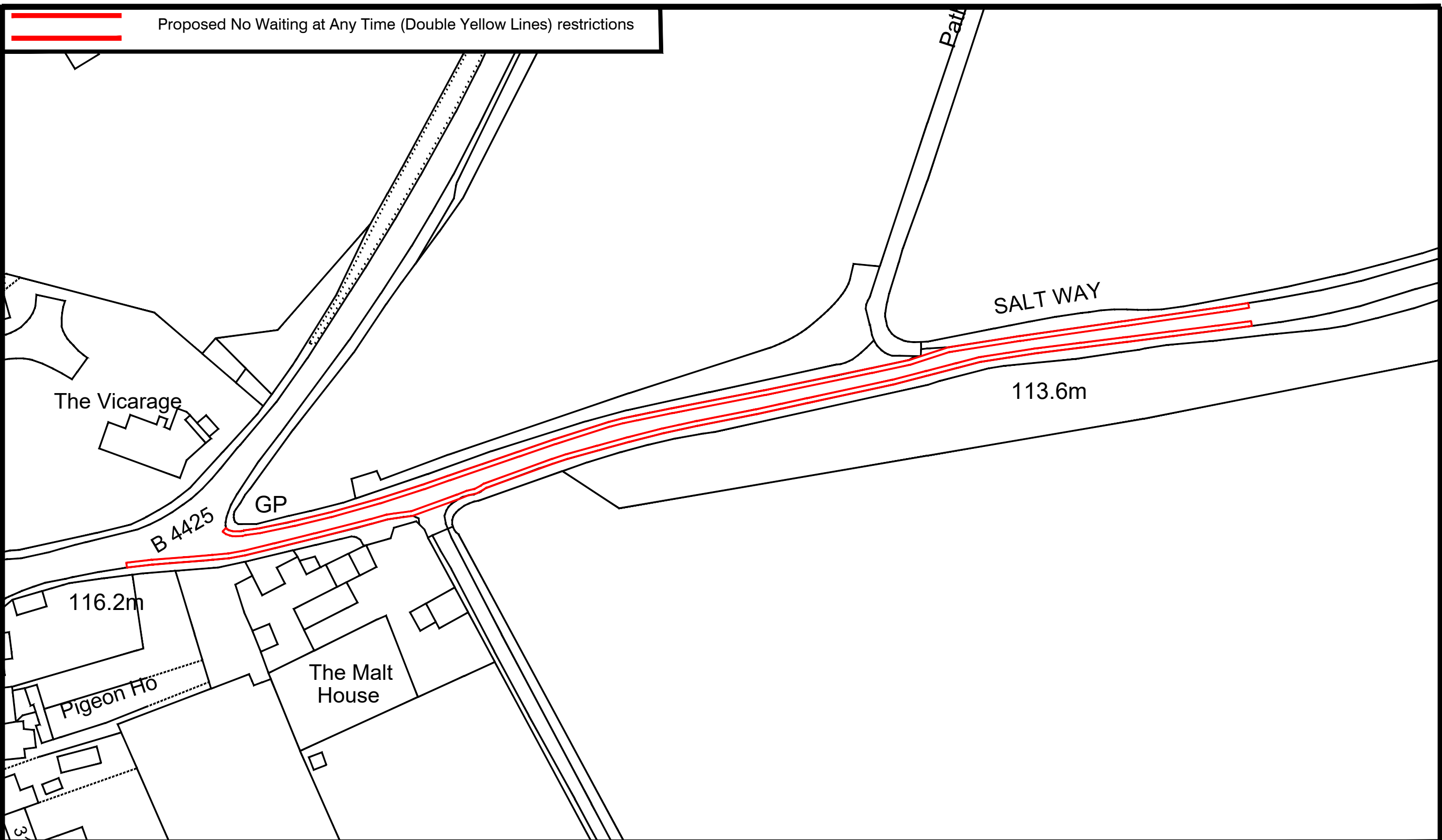

ADL House
 The Oaklands Business Park
 Yate, Bristol
 BS37 5NA
 Tel : 01454 332100
 Fax : 01454 327983
 E-Mail : Will@TROldt.CO.UK

- NOTES**
1. PRELIMINARY DESIGN PROVIDED FOR ILLUSTRATIVE PURPOSES ONLY. ALL DETAILS ARE SUBJECT TO INCLUDING CHECKING STATUTORY SERVICE APPARATUS.
 2. DO NOT SCALE FROM THIS DRAWING.
 3. BACKGROUND PLAN IS BASED UPON A DIGITAL OSBASE.
 4. ALL DETAILS TO BE CONFIRMED ON SITE AND ON A TOPOGRAPHICAL SURVEY.
 5. ALL TRACKS ASSUME GRADIENTS AND CAMBERS DO NOT EXCEED 1:60 AND 1:40 RESPECTIVELY OTHERWISE VEHICLE MANOEUVRABILITY MAY BE AFFECTED.
 6. ALL LAND OWNERSHIP DETAILS, EXTENT OF ADOPTED HIGHWAY AND RIGHTS OF WAY TO BE CONFIRMED.
 7. ASSUMES ALL LANDSCAPING CAN BE ALTERED AND NO TREES ARE SUBJECT TO TPO.
- © Copyright Traffic Regulation Orders Ltd

AMENDMENTS		
REF.	DATE	DESCRIPTION

ADL Job No. 5227-17

Project Salt Way Bibury			
Title Proposed No Waiting at Any Time Restrictions			
Date Feb 2022		Drawn WC	
Checked WW	Date 21.02.22	Approved TH	Date 21.02.22
Scale NTS@A3	Drg No. 5227-17-006		Rev.