

	Existing No Waiting at Any Time (Double Yellow Lines) restrictions
	Proposed No Waiting at Any Time (Double Yellow Lines) restrictions
	Proposed No Waiting Monday-Sunday 8am-6pm (Single Yellow Line) restrictions

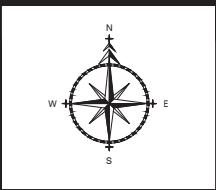
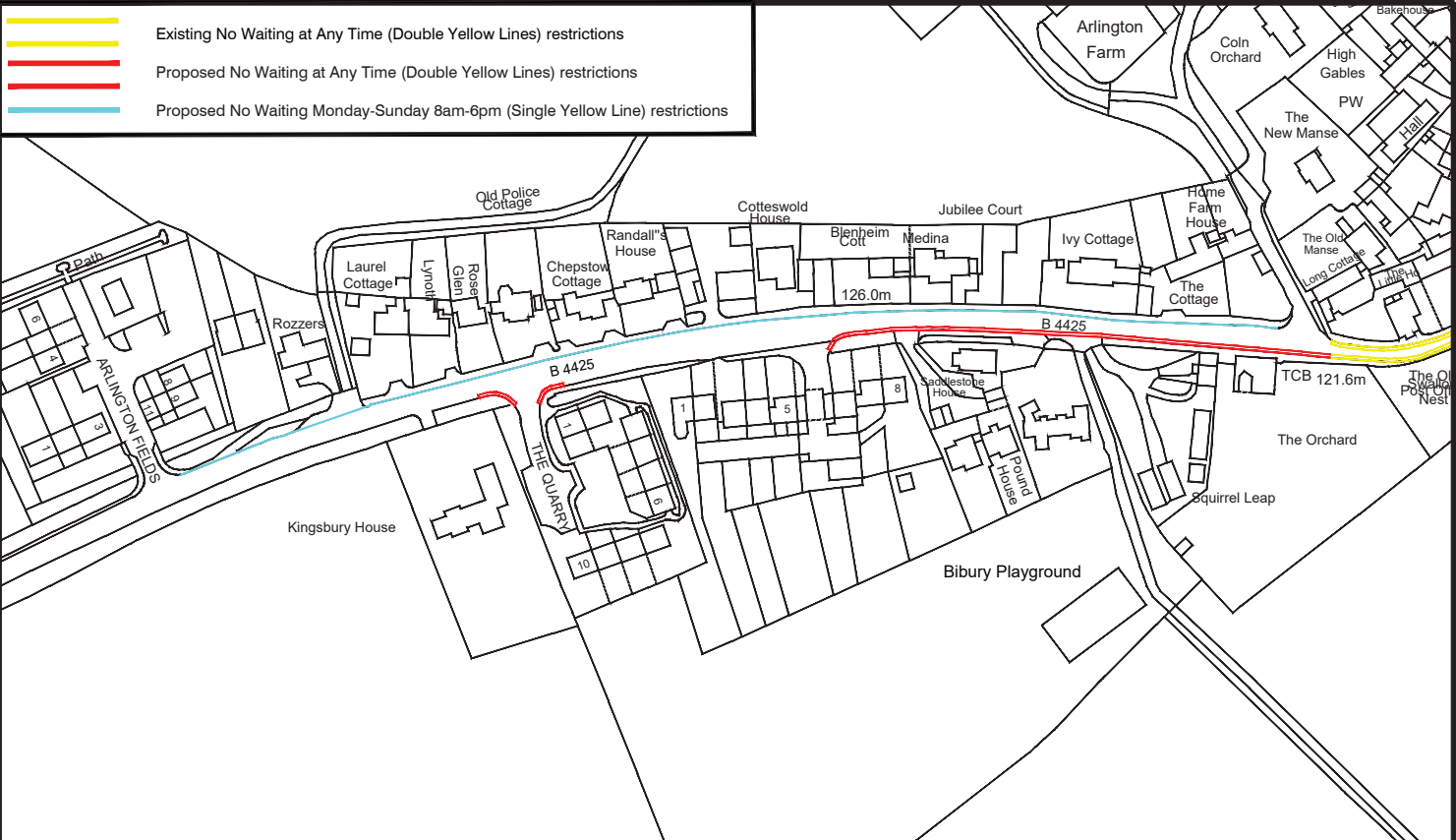

TRO TRAFFIC REGULATION ORDERS LTD

ADL House
The Oaklands Business Park
Yate, Bristol
BS37 5NA
Tel : 01454 332100
Fax : 01454 327953
E-Mail : will@TROtd.CO.UK

NOTES

1. PRELIMINARY DESIGN PROVIDED FOR ILLUSTRATIVE PURPOSES ONLY. ALL DETAILS ARE SUBJECT TO INCLUDING CHECKING. STATUTORY SERVICE APPLICANTS.
2. DO NOT SCALE FROM THIS DRAWING.
3. BACKGROUND PLAN IS BASED UPON A DIGITAL OSBASE.
4. ALL DETAILS TO BE CONFIRMED ON SITE AND ON A TOPOGRAPHICAL SURVEY.
5. ALL TRACKS ASSUME GRADIENTS AND CAMBERS DO NOT EXCEED 1:60 AND 1:40 RESPECTIVELY OTHERWISE VEHICLE MANOEUVRABILITY MAY BE AFFECTED.
6. ALL LAND OWNERSHIP DETAILS EXTENT OF ADOPTED HIGHWAY AND RIGHTS OF WAY TO BE CONFIRMED.
7. ASSUMES ALL LANDSCAPING CAN BE ALTERED AND NO TREES ARE SUBJECT TO TPO.

© Copyright Traffic Regulation Orders Ltd

AMENDMENTS		
REF.	DATE	DESCRIPTION

ADL Job No. 5227-17

Project B4425 (Western Extent) Bibury			
Title Proposed No Waiting at Any Time Restrictions			
Date	Nov 2022	Drawn	LO
Checked	WC	Date	04.11.22
Approved	TH	Date	04.11.22
Scale	NTS@A3	Job No.	5227-17-001

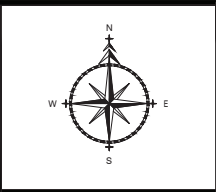
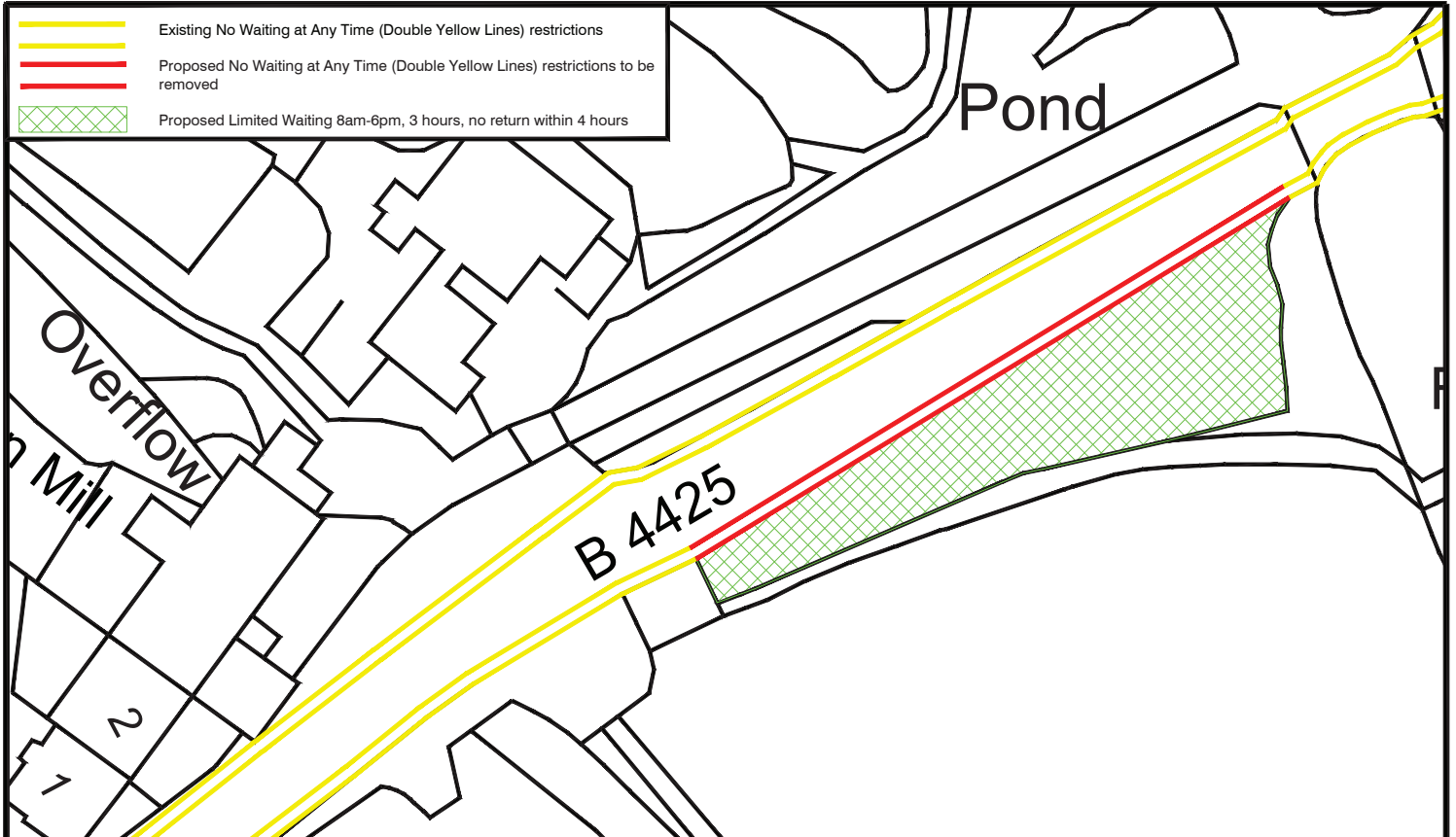

TRO TRAFFIC REGULATION ORDERS LTD

ADL House
The Oaklands Business Park
Yate, Bristol
BS37 5NA
Tel : 01454 332100
Fax : 01454 327953
E-Mail : will@TROldt.CO.UK

NOTES

1. PRELIMINARY DESIGN PROVIDED FOR ILLUSTRATIVE PURPOSES ONLY. ALL DETAILS ARE SUBJECT TO INCLUDING CHECKING STATUTORY SERVICE APPARATUS.
2. DO NOT SCALE FROM THIS DRAWING.
3. BACKGROUND PLAN IS BASED UPON A DIGITAL OSBASE.
4. ALL DETAILS TO BE CONFIRMED ON SITE AND ON A TOPOGRAPHICAL SURVEY.
5. ALL TRACKS ASSUME GRADIENTS AND CAMBERS DO NOT EXCEED 1:60 AND 1:40 RESPECTIVELY OTHERWISE VEHICLE MANOEUVRABILITY MAY BE AFFECTED.
6. ALL LAND OWNERSHIP DETAILS EXTENT OF ADOPTED HIGHWAY AND RIGHTS OF WAY TO BE CONFIRMED.
7. ASSUMES ALL LANDSCAPING CAN BE ALTERED AND NO TREES ARE SUBJECT TO TPO.

© Copyright Traffic Regulation Orders Ltd

AMENDMENTS		
REF.	DATE	DESCRIPTION

ADL Job No. 5227-17

Project Car Park & Bridge Bibury			
Title Proposed Restrictions			
Date Nov 2022		Drawn LO	
Checked WC	Date 04.11.22	Approved TH	Date 04.11.22
Scale	Proj No. NTS0A3	5227-17-002	Rev.

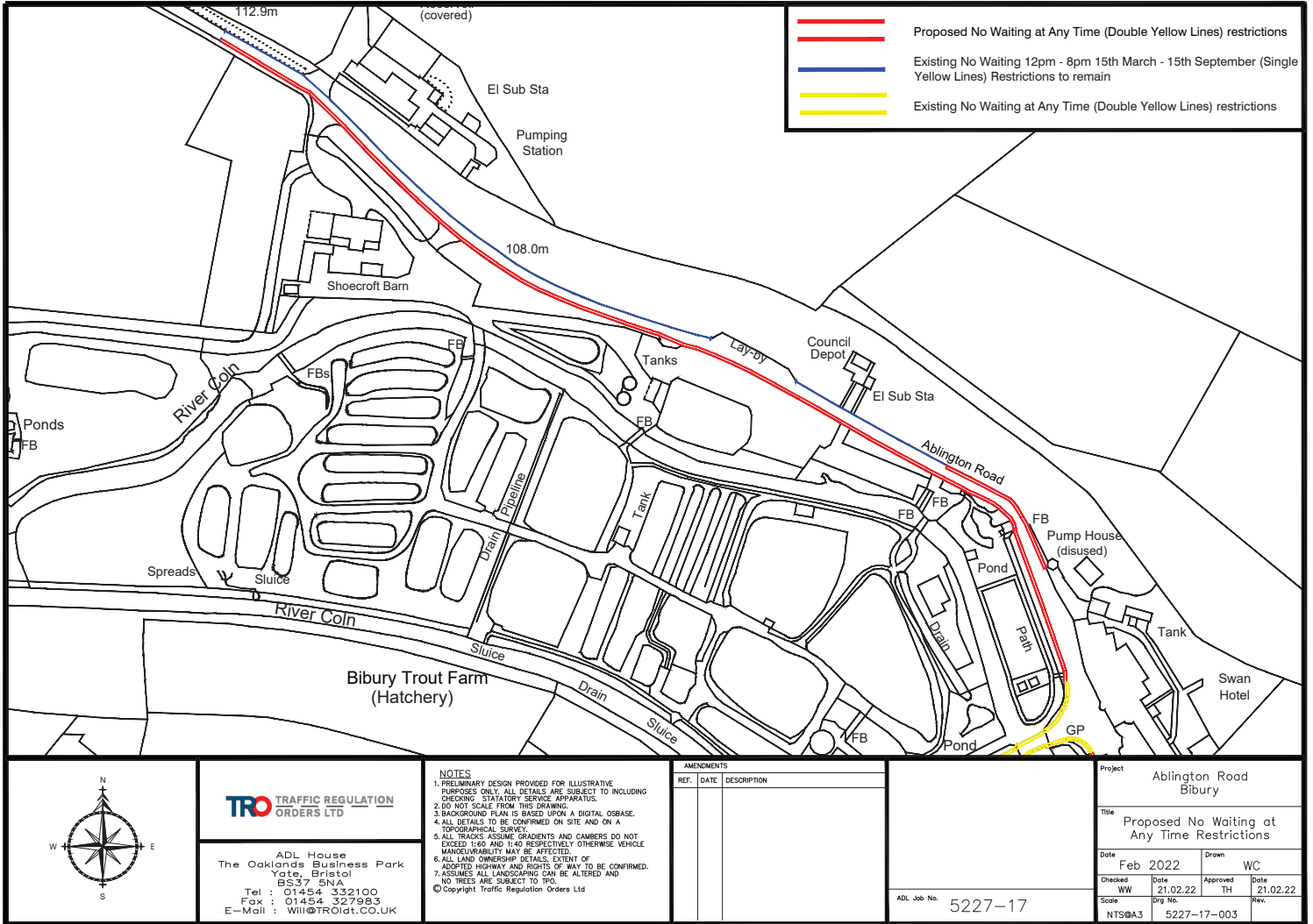

	Proposed No Waiting at Any Time (Double Yellow Lines) restrictions
	Existing No Waiting 12pm - 8pm 15th March - 15th September (Single Yellow Lines) Restrictions to remain
	Existing No Waiting at Any Time (Double Yellow Lines) restrictions

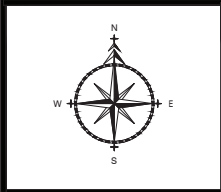

TRO TRAFFIC REGULATION ORDERS LTD

ADL House
The Oaklands Business Park
Yate, Bristol
BS37 5NA
Tel : 01454 332100
Fax : 01454 327953
E-Mail : Will@TROidt.CO.UK

NOTES

1. PRELIMINARY DESIGN PROVIDED FOR ILLUSTRATIVE PURPOSES ONLY. ALL DETAILS ARE SUBJECT TO INCLUDING CHECKING STATUTORY SERVICE APPROPRIATE.
2. DO NOT SCALE FROM THIS DRAWING.
3. BACKGROUND PLAN IS BASED UPON A DIGITAL OSBASE.
4. ALL DETAILS TO BE CONFIRMED ON SITE AND ON A TOPOGRAPHICAL SURVEY.
5. ALL TRACKS ASSUME GRADIENTS AND CAMBERS DO NOT EXCEED 1:60 AND 1:40 RESPECTIVELY OTHERWISE VEHICLE MANOEUVRABILITY MAY BE AFFECTED.
6. ALL LAND OWNERSHIP DETAILS EXTENT OF ADOPTED HIGHWAY AND RIGHTS OF WAY TO BE CONFIRMED.
7. ASSUMES ALL LANDSCAPING CAN BE ALTERED AND NO TREES ARE SUBJECT TO TPO.

© Copyright Traffic Regulation Orders Ltd

AMENDMENTS		
REF.	DATE	DESCRIPTION

ADL Job No. 5227-17

Project Ablington Road Bibury			
Title Proposed No Waiting at Any Time Restrictions			
Date Feb 2022	Drawn WC		
Checked WW	Date 21.02.22	Approved TH	Date 21.02.22
Scale NTS@A3	Fig No. 5227-17-003	Rev.	

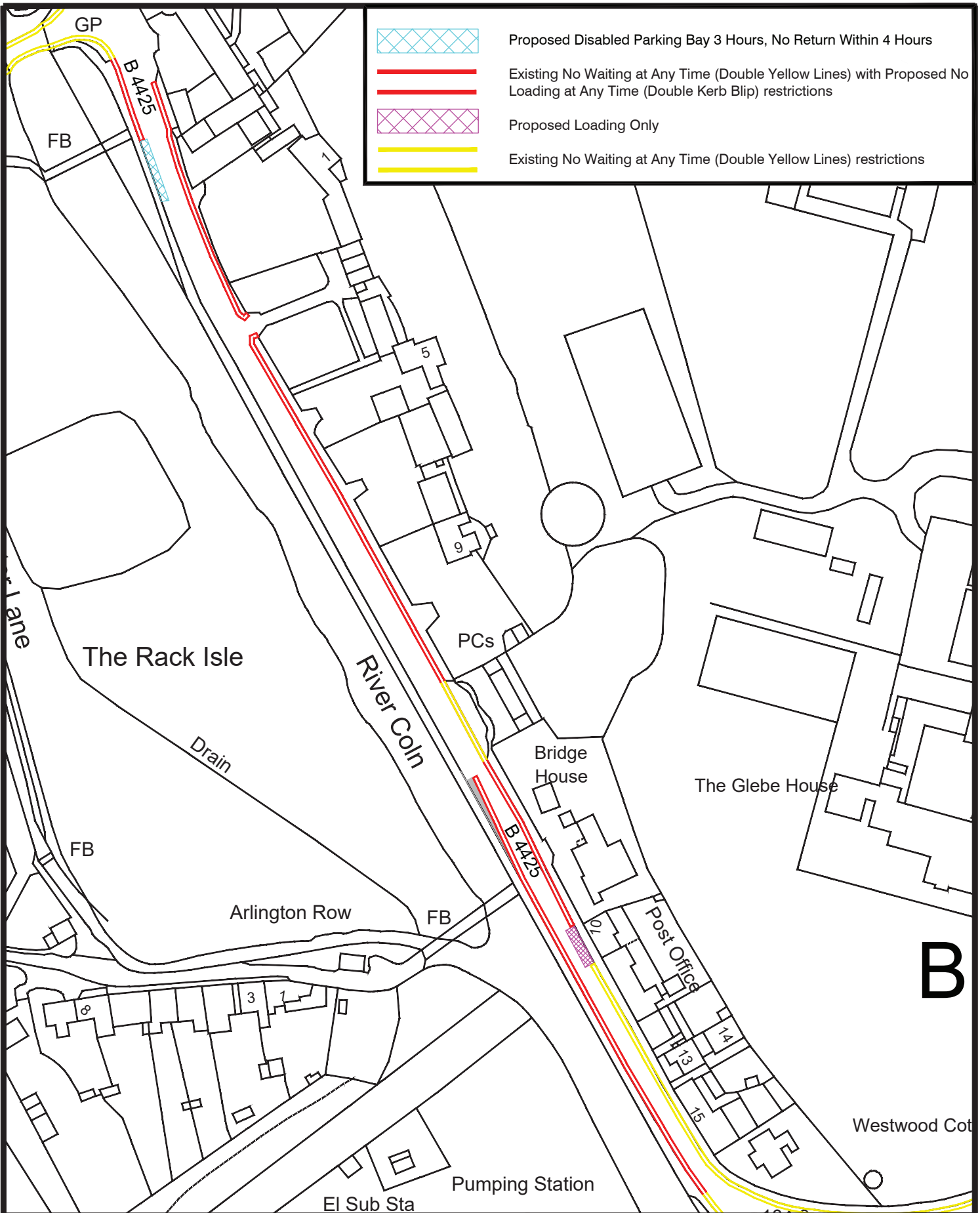

Proposed Disabled Parking Bay 3 Hours, No Return Within 4 Hours



Existing No Waiting at Any Time (Double Yellow Lines) with Proposed No Loading at Any Time (Double Kerb Blip) restrictions



Proposed Loading Only



Existing No Waiting at Any Time (Double Yellow Lines) restrictions



TRO TRAFFIC REGULATION ORDERS LTD

ADL House
The Oaklands Business Park
Yate, Bristol
BS37 5NA
Tel : 01454 332100
E-Mail : CAD@TROLTD.CO.UK

NOTES

1. PRELIMINARY DESIGN PROVIDED FOR ILLUSTRATIVE PURPOSES ONLY. ALL DETAILS ARE SUBJECT TO INCLUDING CHECKING STATUTORY SERVICE APPARATUS.
 2. DO NOT SCALE FROM THIS DRAWING.
 3. BACKGROUND PLAN IS BASED UPON A DIGITAL OSBASE TOPOGRAPHICAL SURVEY.
 4. ALL DETAILS TO BE CONFIRMED ON SITE AND ON A TOPOGRAPHICAL SURVEY.
 5. ALL TRACKS ASSUME GRADIENTS AND CAMBERS DO NOT EXCEED 1:60 AND 1:40 RESPECTIVELY OTHERWISE VEHICLE MANOEUVRABILITY MAY BE AFFECTED.
 6. ALL LAND OWNERSHIP DETAILS, EXTENT OF ADOPTED HIGHWAY AND RIGHTS OF WAY TO BE CONFIRMED.
 7. ASSUMES ALL LANDSCAPING CAN BE ALTERED AND NO TREES ARE SUBJECT TO TPO.
- © Copyright Traffic Regulation Orders Ltd

AMENDMENTS

REF.	DATE	DESCRIPTION

ADL Job No. 5227-17

Project The Street (B4425) Bibury

Title Proposed Restrictions

Date	Nov 2022	Drawn	LO
Checked	WC	Date	04.11.22
Approved	TH	Date	04.11.22
Scale		Drw No.	
NTS @ A3		5227-17-004	

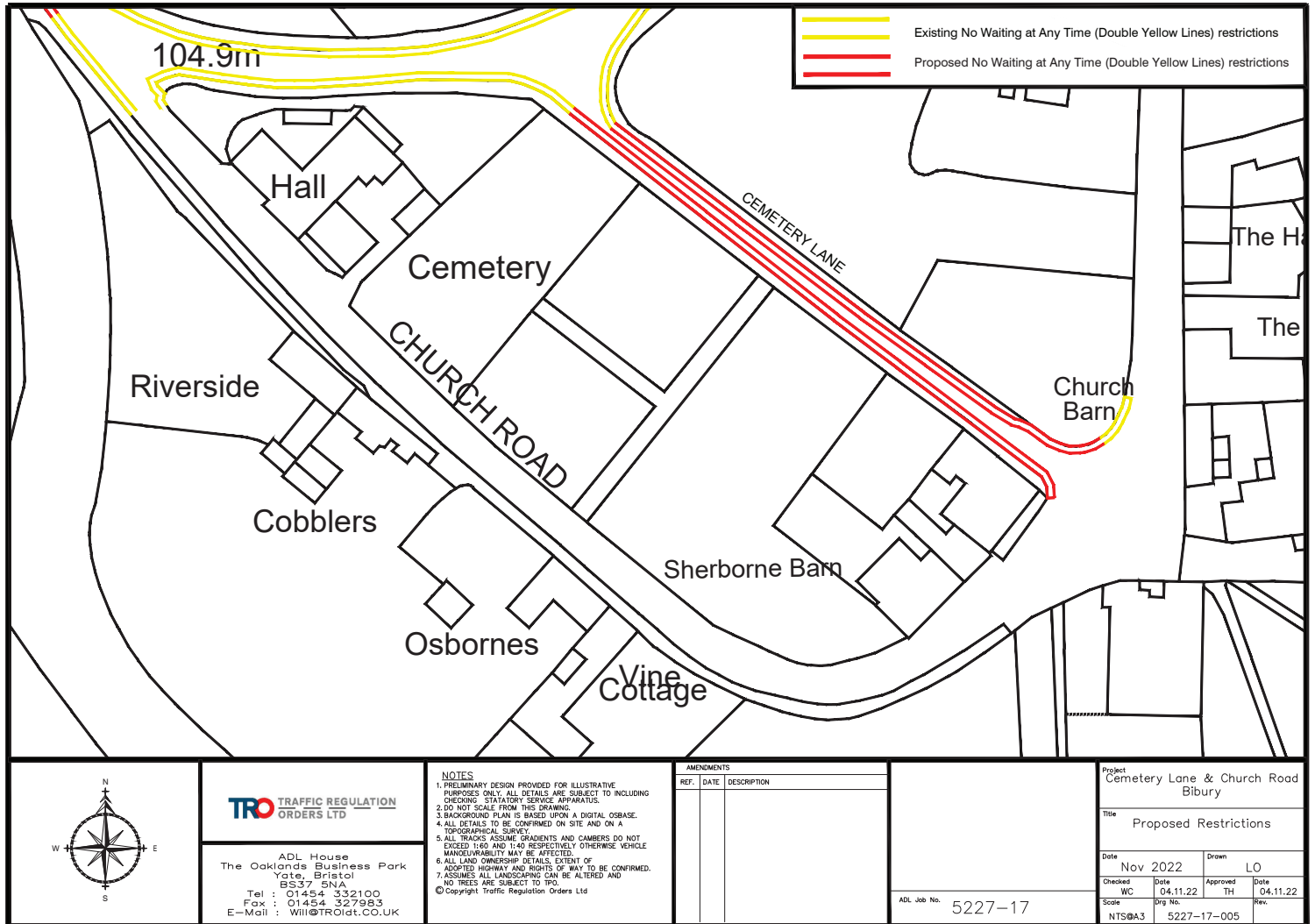

——— Existing No Waiting at Any Time (Double Yellow Lines) restrictions
——— Proposed No Waiting at Any Time (Double Yellow Lines) restrictions

NOTES

1. PRELIMINARY DESIGN PROVIDED FOR ILLUSTRATIVE PURPOSES ONLY. ALL DETAILS ARE SUBJECT TO INCLUDING CHECKING STATUTORY SERVICE APPARATUS.
2. DO NOT SCALE FROM THIS DRAWING.
3. BACKGROUND PLAN IS BASED UPON A DIGITAL OSBASE.
4. ALL DETAILS TO BE CONFIRMED ON SITE AND ON A TOPOGRAPHICAL SURVEY.
5. ALL TRACKS ASSUME GRADIENTS AND CAMBERS DO NOT EXCEED 1:60 AND 1:40 RESPECTIVELY OTHERWISE VEHICLE MANOEUVRABILITY MAY BE AFFECTED.
6. ALL LAND OWNERSHIP DETAILS EXTENT OF ADOPTED HIGHWAY AND RIGHTS OF WAY TO BE CONFIRMED.
7. ASSUMES ALL LANDSCAPING CAN BE ALTERED AND NO TREES ARE SUBJECT TO TPO.

© Copyright Traffic Regulation Orders Ltd

AMENDMENTS		
REF.	DATE	DESCRIPTION

ADL Job No. 5227-17

Project Cemetery Lane & Church Road Bibury			
Title Proposed Restrictions			
Date	Nov 2022	Drawn	LO
Checked	WC	Date	04.11.22
Approved	TH	Date	04.11.22
Scale	NTS@A3	Proj No.	5227-17-005
Rev.			



TRO TRAFFIC REGULATION ORDERS LTD

ADL House
The Oaklands Business Park
Yate, Bristol
BS37 5NA
Tel : 01454 332100
Fax : 01454 327953
E-Mail : Will@TROldt.CO.UK

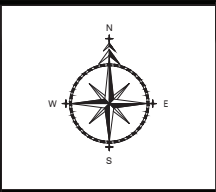
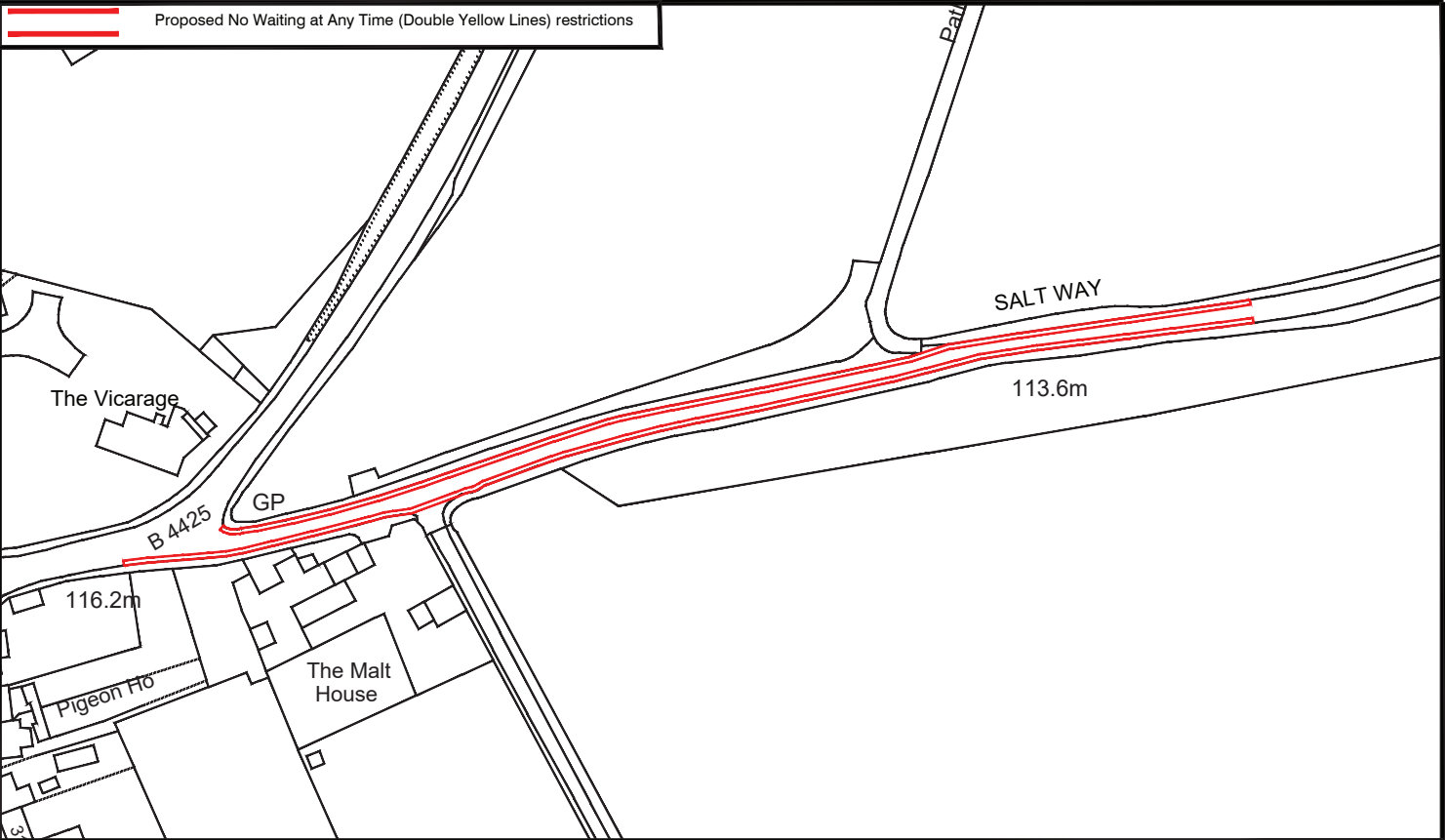

TRO TRAFFIC REGULATION ORDERS LTD

ADL House
The Oaklands Business Park
Yate, Bristol
BS37 5NA
Tel : 01454 332100
Fax : 01454 327953
E-Mail : Will@TROldt.CO.UK

NOTES

1. PRELIMINARY DESIGN PROVIDED FOR ILLUSTRATIVE PURPOSES ONLY. ALL DETAILS ARE SUBJECT TO INCLUDING CHECKING STATUTORY SERVICE APPARATUS.
2. DO NOT SCALE FROM THIS DRAWING.
3. BACKGROUND PLAN IS BASED UPON A DIGITAL OSBASE.
4. ALL DETAILS TO BE CONFIRMED ON SITE AND ON A TOPOGRAPHICAL SURVEY.
5. ALL TRACKS ASSUME GRADIENTS AND CAMBERS DO NOT EXCEED 1:60 AND 1:40 RESPECTIVELY OTHERWISE VEHICLE MANOEUVRABILITY MAY BE AFFECTED.
6. ALL LAND OWNERSHIP DETAILS EXTENT OF ADOPTED HIGHWAY AND RIGHTS OF WAY TO BE CONFIRMED.
7. ASSUMES ALL LANDSCAPING CAN BE ALTERED AND NO TREES ARE SUBJECT TO TPO.

© Copyright Traffic Regulation Orders Ltd

AMENDMENTS		
REF.	DATE	DESCRIPTION

ADL Job No. 5227-17

Project				Salt Way Bibury											
Title								Proposed No Waiting at Any Time Restrictions							
Date				Feb 2022				Drawn				WC			
Checked		Date		Approved		Date		Checked		Date		Approved		Date	
WW		21.02.22		TH		21.02.22		WW		21.02.22		TH		21.02.22	
Scale				NTS@A3				Job No.				5227-17-006			