 Proposed No Waiting at Any Time (Double Yellow Lines) restrictions

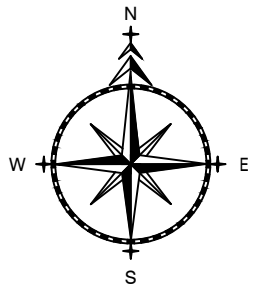
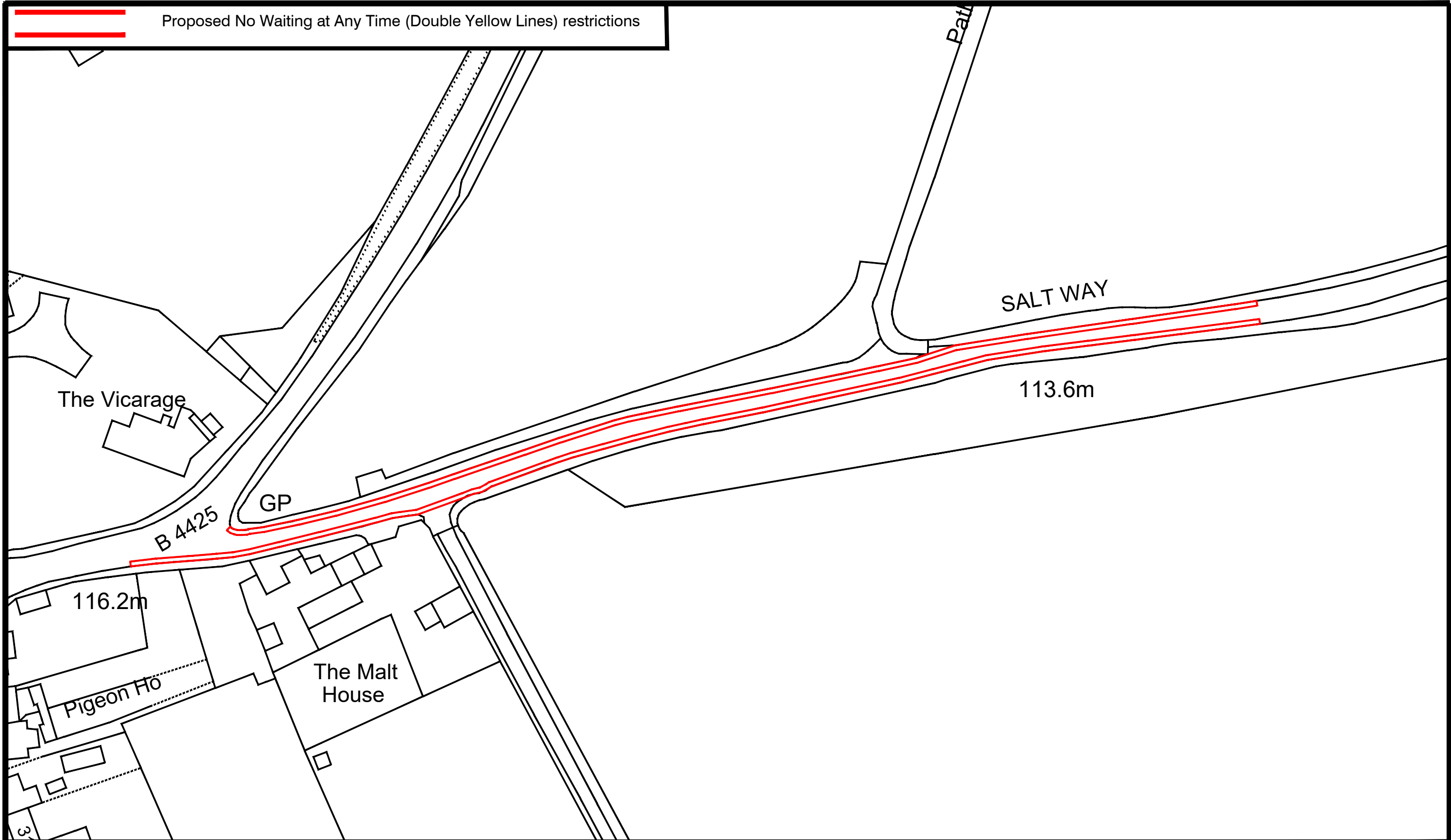

ADL House
 The Oaklands Business Park
 Yate, Bristol
 BS37 5NA
 Tel : 01454 332100
 Fax : 01454 327983
 E-Mail : Will@TROldt.CO.UK

- NOTES**
1. PRELIMINARY DESIGN PROVIDED FOR ILLUSTRATIVE PURPOSES ONLY. ALL DETAILS ARE SUBJECT TO INCLUDING CHECKING STATUTORY SERVICE APPARATUS.
 2. DO NOT SCALE FROM THIS DRAWING.
 3. BACKGROUND PLAN IS BASED UPON A DIGITAL OSBASE.
 4. ALL DETAILS TO BE CONFIRMED ON SITE AND ON A TOPOGRAPHICAL SURVEY.
 5. ALL TRACKS ASSUME GRADIENTS AND CAMBERS DO NOT EXCEED 1:60 AND 1:40 RESPECTIVELY OTHERWISE VEHICLE MANOEUVRABILITY MAY BE AFFECTED.
 6. ALL LAND OWNERSHIP DETAILS, EXTENT OF ADOPTED HIGHWAY AND RIGHTS OF WAY TO BE CONFIRMED.
 7. ASSUMES ALL LANDSCAPING CAN BE ALTERED AND NO TREES ARE SUBJECT TO TPO.
- © Copyright Traffic Regulation Orders Ltd

AMENDMENTS		
REF.	DATE	DESCRIPTION

ADL Job No. 5227-17

Project Salt Way Bibury			
Title Proposed No Waiting at Any Time Restrictions			
Date Feb 2022		Drawn WC	
Checked WW	Date 21.02.22	Approved TH	Date 21.02.22
Scale NTS@A3	Drg No. 5227-17-006		Rev.